

Sanitary Mixer FRESH

Sink Mixer

Datasheet
00133
00134

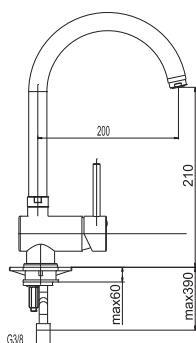

00133

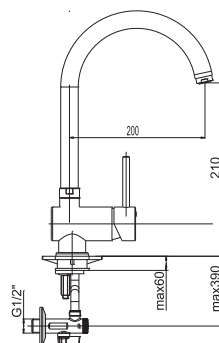

00134

Model	Colour	Contents of package
00133	Chrome	/
00134	Chrome	Ball valve

Contents and colour

Body: brass acc. EN 12164, chrom plated
Cartridge: 40 mm
Handle: brass, chrom plated
Sealing elements: rubber EPDM

Construction

Connections:	Flexible connecting hose for domestic tap fittings G3/8x450
Recommendable pressure:	Working pressure: up to 3 - 5 bar
Maximum pressure:	Working pressure: up to 8 bar
Minimum pressure:	Working pressure: up to 0,5 bar
Recommendable temp.:	Working temperature: 5 - 65°C
Maximum temperature:	Working temperature: 80°C

Specification

You have to wash out all pipes before assembling.

Connect sanitary mixer and primary water pipe with flexible hose. Remove aerator and rotate mixer handle in totally open position. Slowly open pipe valves and manipulate with mixer handle in all positions.

Repairment of the mixer must be always performed by a qualified person. After assembling, we advice to wash out mixer for one hour.

We recommend to reduce water pressure over 5 bar with suitable pressure reducer.

Instruction for assembling and maintenance